

UNPLATTED

UNPLATTED

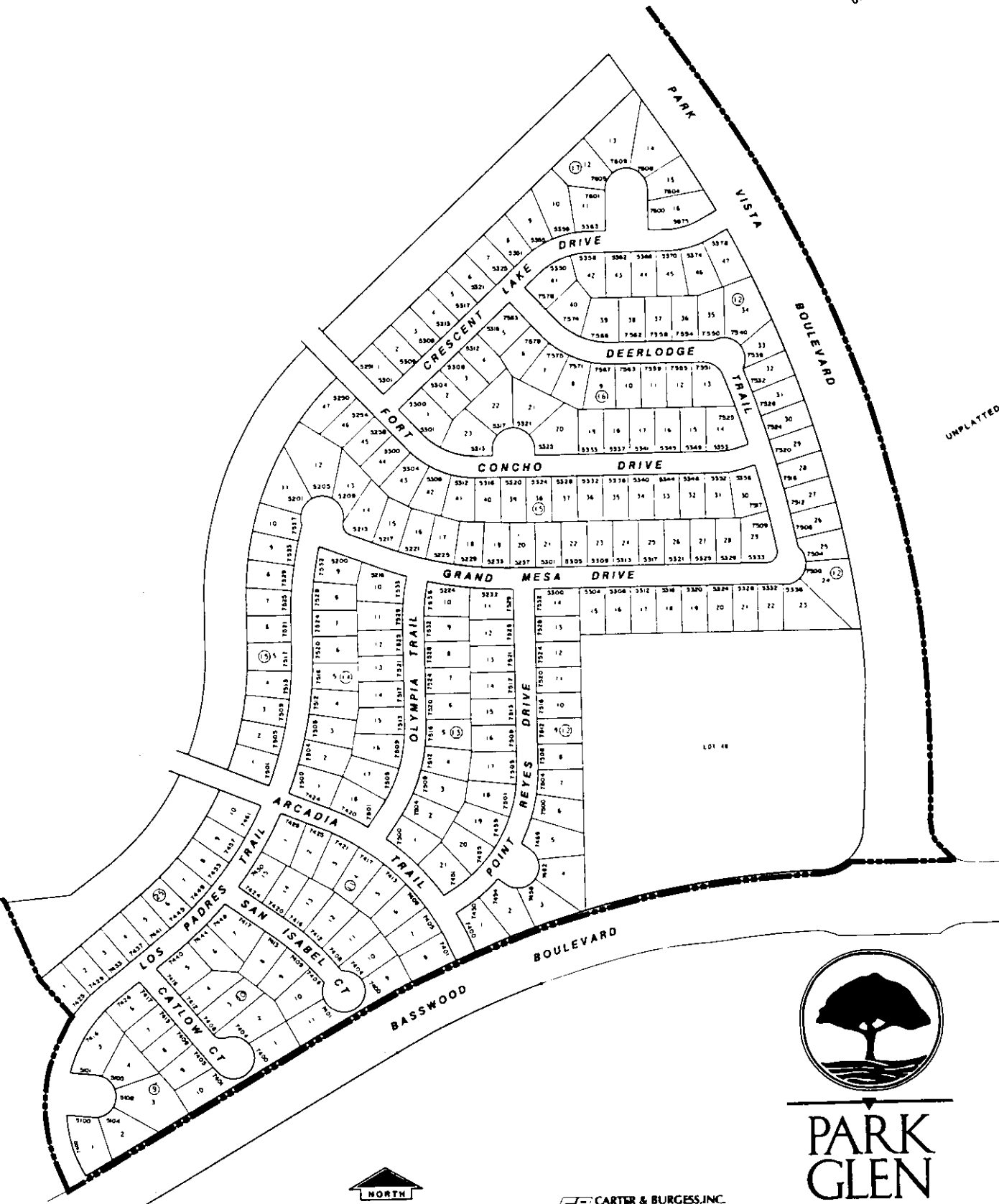

**PARK
GLEN**

PHASE 1



0 100 200 300 400
GRAPHIC SCALE IN FEET

CARTER & BURGESS, INC.
ENGINEERS · PLANNERS · SURVEYORS
1106 HAZEN STREET · FORT WORTH, TEXAS 76104
(817) 522-2411 · METRO OFFICE